

RG-100

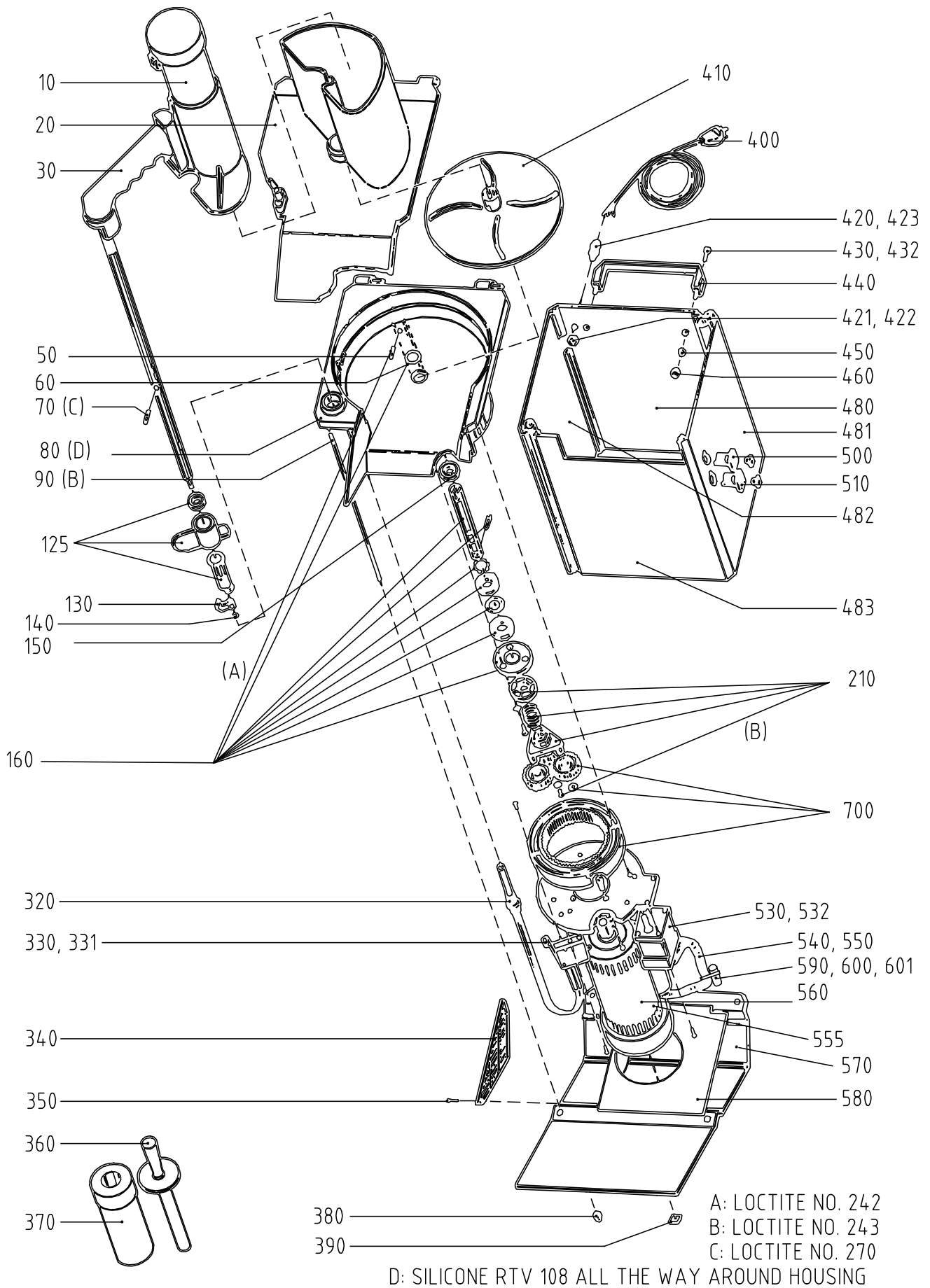

**RG-100**

No. on drawing	Item No.	Description	Pcs
10	83038	Pestle	1
20	1165	Feed cylinder compl.	1
30	1309	Feeder plate compl. incl shaft	1
50	1054	Pin	1
60	10262	Seal ring V-18S	1
70	1290	Guide pin	1
80	1400	Knife chamber RG-100/200	1
90	1039	Screw L=316	4
125	1091	Locking handle compl.	1
130	14305	Activator compl.	1
140	10275	Locking washer RS 4	1
150	10259	Rubber seal washer 18X30X7	1
160	1401	Knife shaft kompl RG-100.	1
210	1403	Brake kompl. RG-100/200/250.	1
320	15354	Magnetic switch HM-S-16	1
330	1101	Microswitch unit compl. CE	1
331	1584	Micro switch unit	1
340	1096	Louver kit	1
350	14248	Screw KFX-H ST3,5X9,5 A2 70	6
360	81066	Pestle	1
370	1155	Tube	1
380	1267	Nut,domed head M5	4
390	10273	Rubber foot SJ 5023 black	4
400	15147	Supply cord CB 1 phase RG-100/200/250/350/VCB-61/VCM-41	1
400	15142	Supply cord CB 3 phse	1
400	15377	Supply cord BS/2.5MS UK	1
400	15278	Suply cord 439/2.4MG SJT	1
410	83032	Ejector plate	1
420	15623	Cable ret. PR 18,5 metal dia12	1
421	15627	Nut PG11	1
422	15692	Nut PG 9 plastic	1
423	15688	Cable retainer, PG9 (8)	1
430	14374	Screw MCS M8X20 A2 70	2
432	10306	Plug	2
440	10043	Handle M443/140	1
450	14088	Lock washer FBB 8.2 A2	2
460	14008	Nut M6M M8 A2 70	2
480	1365	Machine casing back part	1
481	1362	Machine casing right part	1
482	1364	Machine casing left part	1
483	1363	Machine casing front part	1
500	15657	Push button o compl.	1
510	15440	Push button 1 complete	1
530	15813	Contactora 11BG0910A110	1
532	15810	Contactora 11BG0610A230	1
540	1056	Cablage AWG18	1
550	15384	Fuse T100MA	1
555	15397	Capacitor for motor 220/240v	1
560	15752	Motor RG-100,400 3 50	1
560	15753	Motor 110-120 1 60	1
560	15754	Motor 240 1 50	1
570	1249	Base plate RG-200/100 compl.	1
580	22222	Ventilation plate	1
590	15111	RC-circuit 110v	1
600	15110	RC-circuit 230v	1
601	15385	Fuse holder	1
700	1098	Planetwheels and gearing kit	1